

Installation guide

BAMBOOTOUCH® OUTDOOR COMPOSITE TERRACE

(on hard or stabilized surface)

Simplified installation guide

1. STRUCTURE :

A good structure is essential to a quality installation. Install the structure according to the current standards. The floor must be able to support the load.

We recommend the use of composite or solid BambooTouch® joists.

To avoid contact between the joists and water, a waterproof membrane should be installed. The use of waterproof strips only under the joists is another possibility.

Lay the joists perpendicular to the direction of the deck, spacing them 32 cm apart for private use and 27 cm apart for commercial use (distance between joists).

Normally, your deck is built with a slope of 1 to 2% to facilitate water drainage.

Installation diagram of the joists

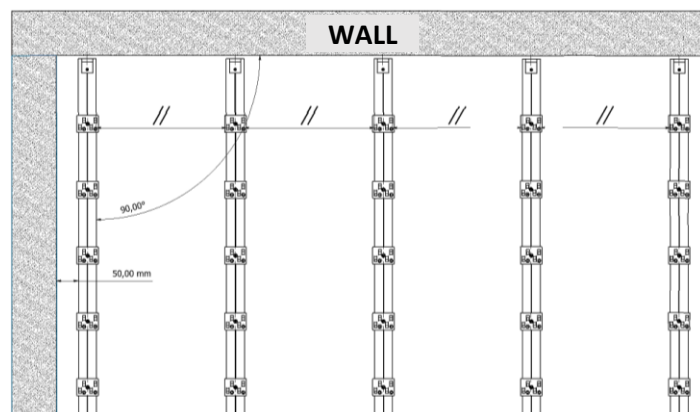

2. SUPPORT AT THE END OF THE JOISTS:

The boards can never be overhanging and unsupported by a joist..

On the edge of the deck, at the head of the plank, a max overhang of 50mm is nevertheless acceptable.

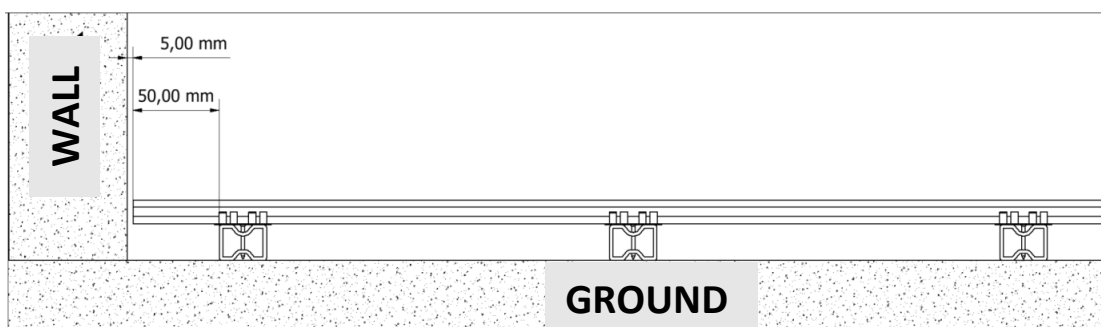

Diagram of the joists, the board and the maximum overhang at the edge of the deck

3. INSTALLATION ON STUDS :

The installation on studs is done in the same way. The joists will simply rest on the blocks.

When using composite joists (30 x 40 mm), we limit the space between blocks to 35 cm for residential use and 30 cm for commercial use.

When using solid bamboo joists (40 x 40 mm), the space between the posts can be up to 60 cm maximum, depending on the use and the weight to be supported.

4. INSTALLATION OF THE PLANKS :

4.1 – Installation of the first plank

Use the clips and the Bambootouch® screws adapted to your product.

Only the use of our clips guarantees the installation

Start by screwing the start clips onto the joists. Take care to pre-drill with a 3mm drill bit (if you use the 4x30 stainless steel screws provided)

Respect a distance of 5 mm between the wall and the first plank.

If the wall is not straight, a compromise in spacing must be sought.

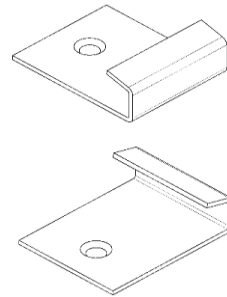
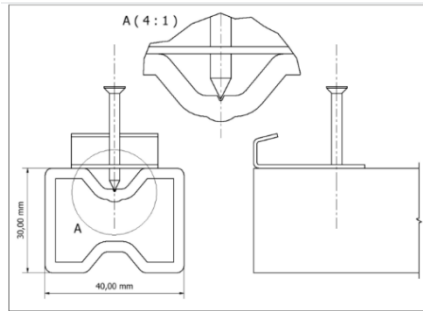
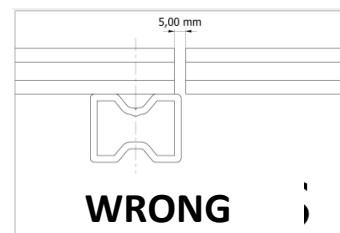
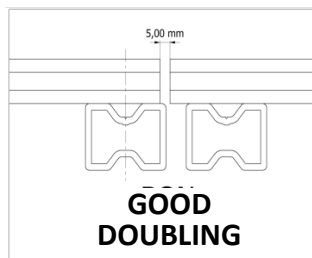
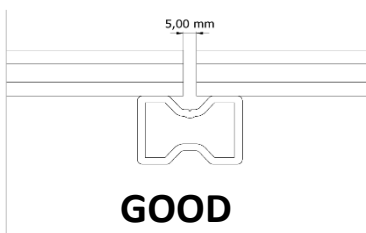

Diagram for fixing the start clips in the start joist

Clips

The ends of the boards must be placed perfectly on the joists.

In case of difficulty, the joist should be doubled.



4.2 – Distance between planks

In the longitudinal direction, be sure to respect a spacing of 5 mm between each plank.

This is an expansion space. Use a clip at each junction between a joist and a plank.

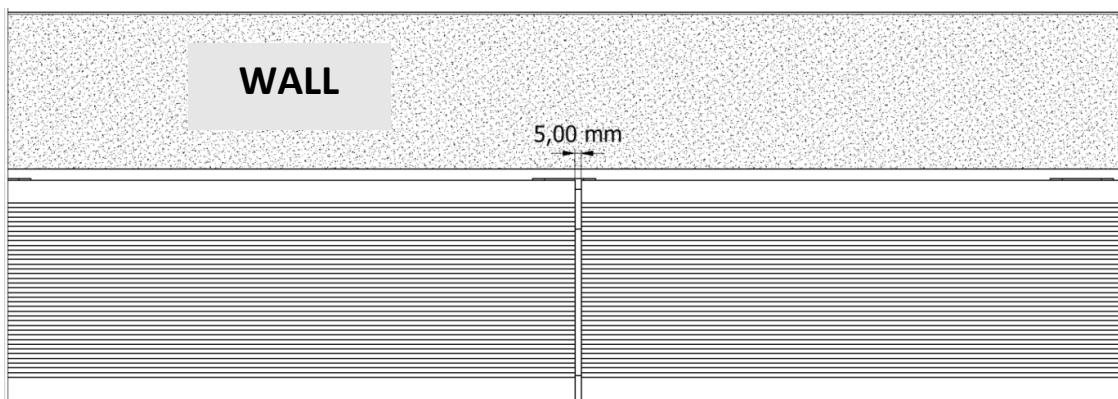

Diagram of space between 2 planks

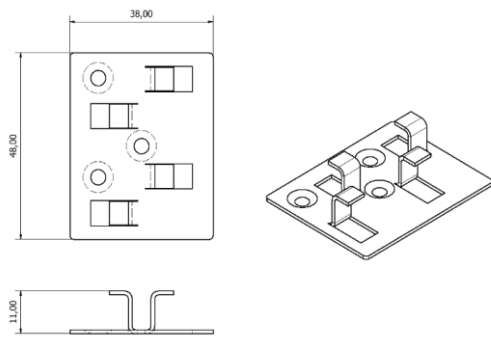

Diagram of the clips for composite plank

4.3 – Blocking of the planks

It is important to secure each plank with a blocking clip to prevent longitudinal slippage. This clip replaces one of the fixing clips and is to be fitted in the same way. However, it should only be tightened once the next row has been fixed! (If you tighten the fixing clip before placing the next plank, you will not be able to position it).

Blocking clip



Longitudinal plank blocking diagram

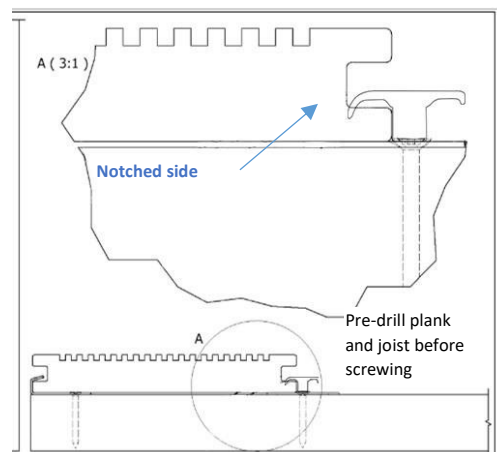

4.4 – Installation of the following planks

Before installing the second row of planks, you must first install and secure the fixing clips. Always pre-drill the joists with a 3 mm drill bit. Use one blocking clip per plank, regardless of their length.

Place your board in the clips. Check that your board is parallel.

You can also use a suitable flooring strap to tighten your boards before installing and screwing on the next clips.

Install the mounting clips and tighten the previous locking clip (the latter is accessible between the second-last plank and the last plank installed. Make sure to use a fine screwdriver head so as not to damage the planks)

Install all following boards accordingly.

4.5 – Finishing touch

There are several ways to achieve a neat finish at the end of the terrace.

The diagram below shows one of the possible solutions.

A plank cut at the right height forms a riser and is fixed laterally to a perpendicular joist.

The longitudinal cut of the 2 grooves will be more aesthetic.

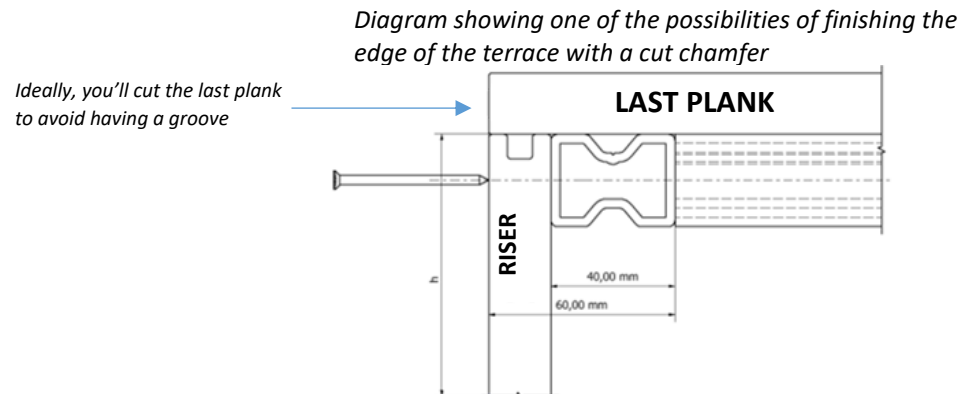

5. COSTING - CALCULATION OF REQUIRED QUANTITIES:

Indicative data for a net surface and without taking into account off-cuts. They do not constitute a commitment on the part of BambooTouch®. Please consult your dealer for advice.

- ✓ Number of planks required:
 - o Multiply the surface area of the terrace by 3.12
 - o Example: for 60m² -> 60 x 3,12 = 187 planks
- ✓ Number of linear meters of joists required:
 - o Multiply the surface of the terrace by 3.5 (residential) or by 4 (commercial) and divide by the length of a joist (2.2m in composite and 2.5m in solid)
 - o For a 60 m² terrace, you will need 60 x 3.5 = 210 linear metres, which will make 210/2.2=96 composite joists.
- ✓ Number of clips per plank:
 - o Start clips: according to the plan (1 per starjoist)
 - o Fixation clips : 20 pieces/m²
 - o Fixation screws : Stainless steel 4 x 30 (pre-drill necessary).